

These symbols mark some of the spectacular trees worth seeking out on your next visit...

0 100 200 300m



Cicilian fir - The true firs often start off as squat plants, growing out before they grow up. Our examples of *Abies cilicica* illustrate this phenomenon well, though there are many other true fir species represented here that do likewise.

Tree guide

-  Cicilian fir
-  Oriental beech
-  *Cedrus libani*
-  *Alnus glutinosa* subsp. *barbata*
-  *Acer heldreichii* subsp. *trautvetteri*

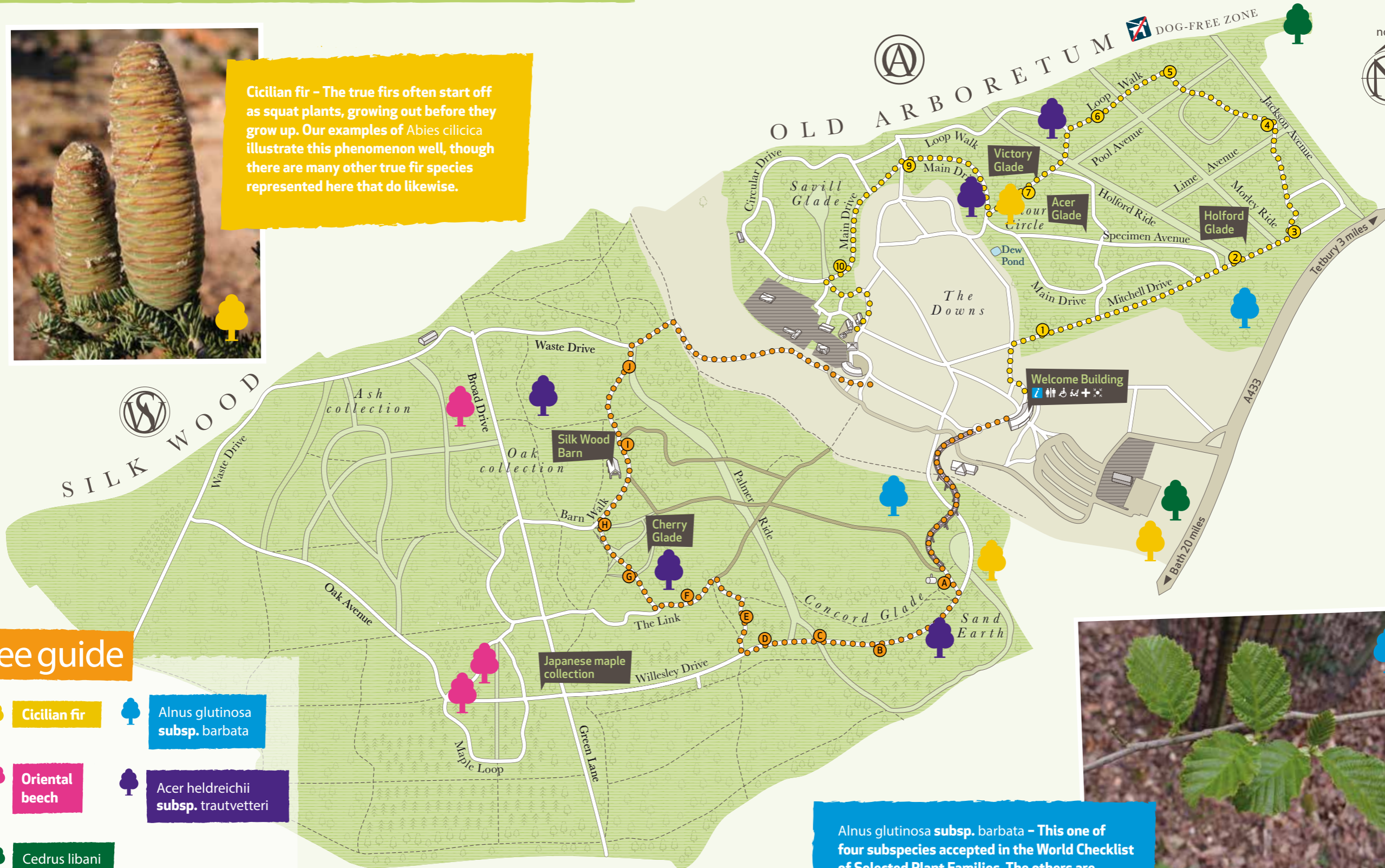

Alnus glutinosa subsp. *barbata* - This one of four subspecies accepted in the World Checklist of Selected Plant Families. The others are *antitaurica*, *betuloides* and *glutinosa*.

▲ Credit: Hugh Angus